

1 Review Components

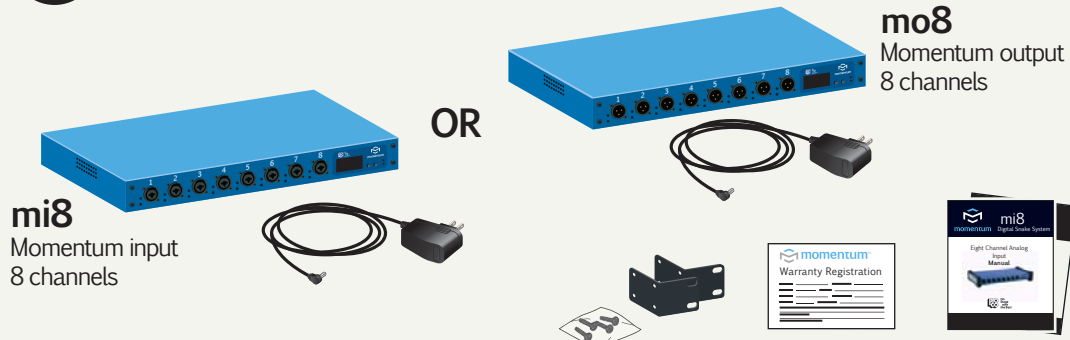

2 Connect Power

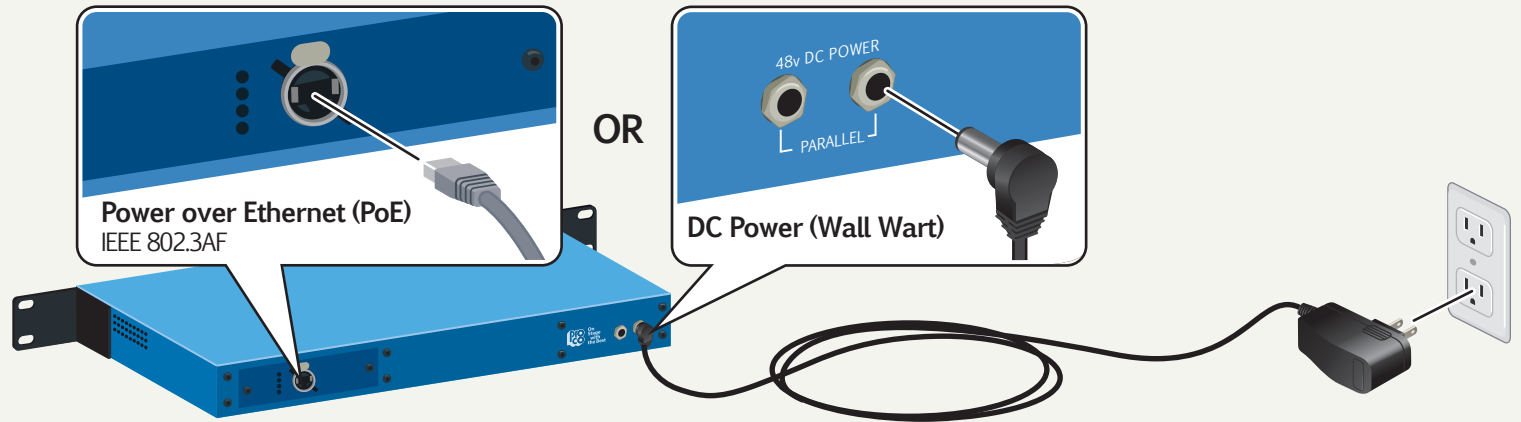

3 Set Start Channel

Note: Each unit has 8 channels.

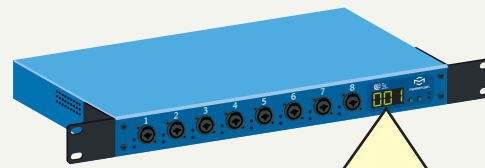

A Tap F2 until Chn displays on screen.

B Tap F1 to enter edit mode. Display alternately flashes three-digit start channel number and Chn.
Note: Each unit's start channel begins with the next increment of 8. (001, 009, 017, 025, etc.)

C Set start channel number:
• Tap F1 to decrease.
• Tap F2 to increase.

D Press and hold F1 and F2 until display stops flashing to save settings.

E Repeat steps A-D for remaining mi8 and mo8 units.

4 Connect Ethernet

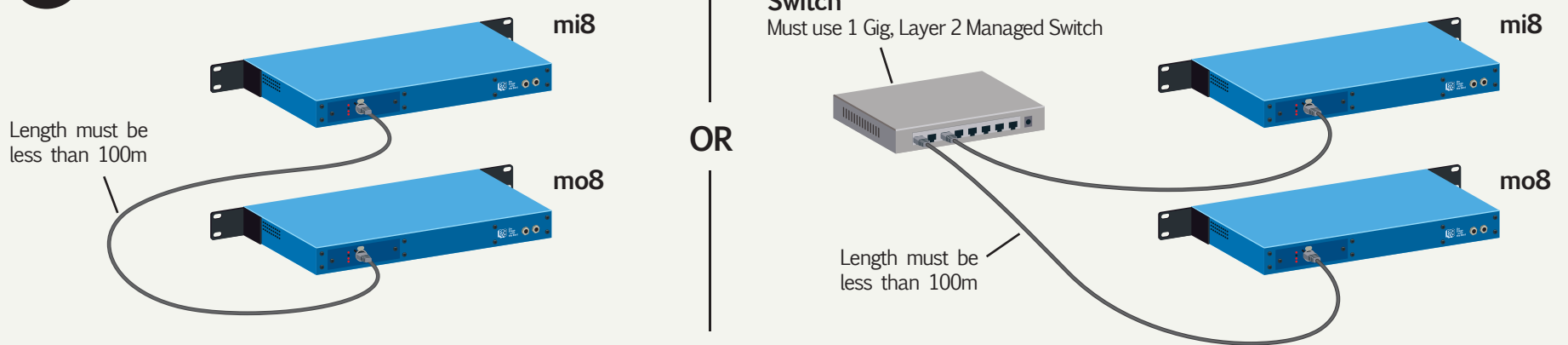

5 Set IP Address

Important: Each unit must have a different IP number.
First mi8 unit must be 001.

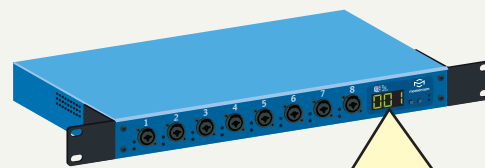

A Tap F2 until Addr displays on screen.

B Tap F1 to enter edit mode. Display alternately flashes three-digit IP number and Addr.
Note: IP number defaults to 001.

C Set IP number value:
• Tap F1 to decrease.
• Tap F2 to increase.

D Press and hold F1 and F2 until display stops flashing to save settings.

E Repeat steps A-D for remaining mi8 and mo8 units.